



# SLIM IMAGEART MEDIA FRAME

The **SLIM IMAGEART MEDIA FRAME** is an easy to use Snap Frame System that accommodates medium size graphics, promotional signage, and backlit materials in nearly a 1" thick frame

With our **SLIM IMAGEART MEDIA FRAME**, medium sized media graphics (up to 96" x 48") are typically printed on a DURATRANS film and backlit by evenly distributed light for beautiful displays that promote any artwork in a thin profile

The **SLIM IMAGEART MEDIA FRAME** may be used for a variety of applications that include:



Branding



Residential



Signage



Restaurants



Custom Fixtures



Hospitality



Retail



Healthcare



Gallery Displays



Custom Art Displays



Custom Art Displays



Bar



Commercial Interior

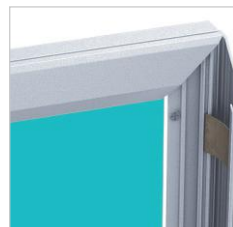

SLIM IMAGEART MEDIA FRAME  
FRONT CORNER



CLOSED SLIM IMAGEART MEDIA  
FRAME CORNER DETAIL



SLIM IMAGEART MEDIA  
FRAME BACK CORNER



SLIM IMAGEART MEDIA FRAME  
WITH MOUNTING BRACKET

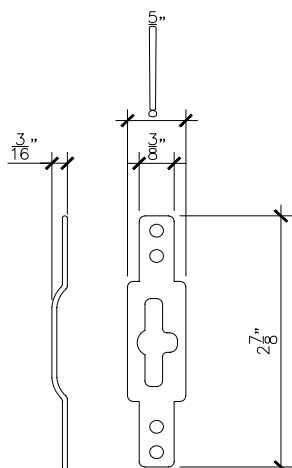

KEYHOLE MOUNTING  
BRACKET

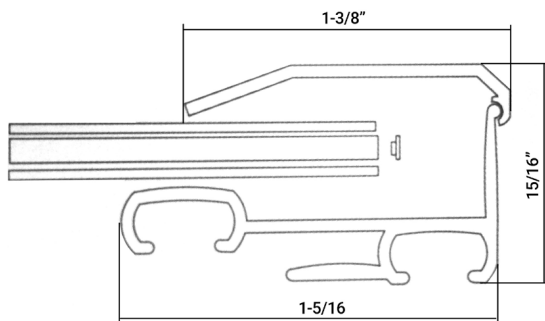

SLIM IMAGEART MEDIA FRAME  
CROSS SECTION DETAIL



# DIMENSIONS

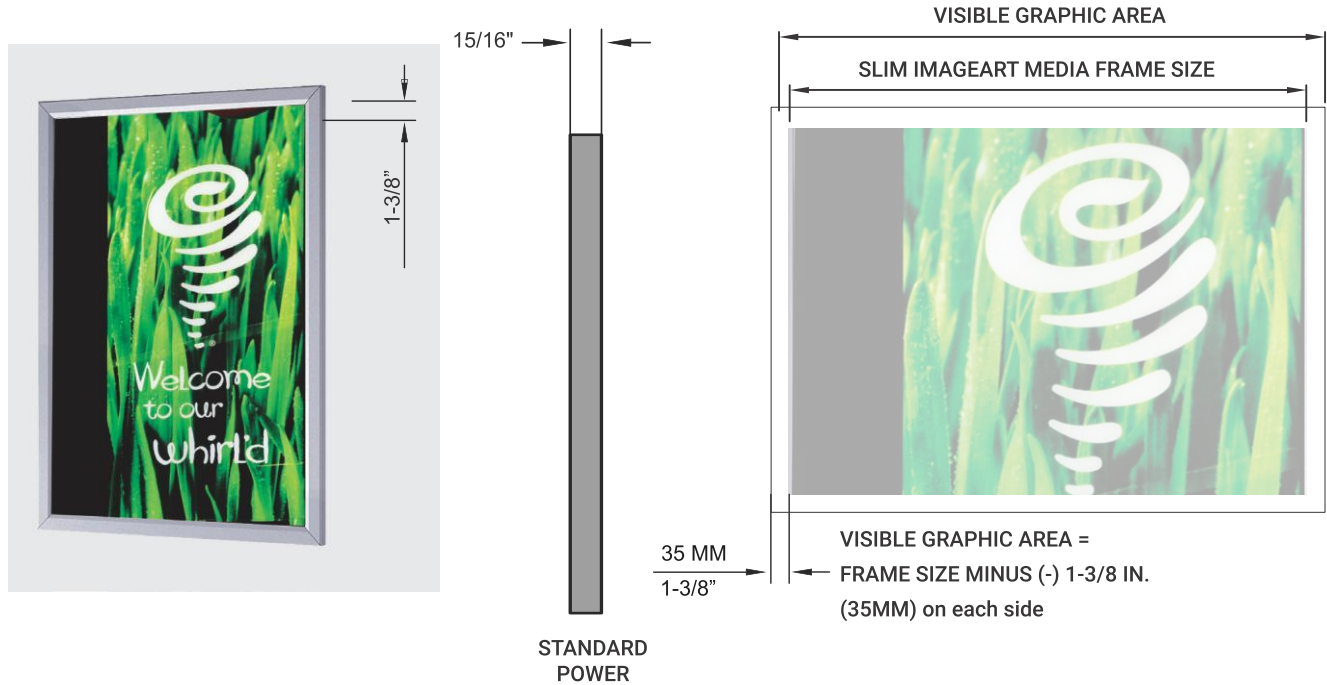

# APPLICATIONS

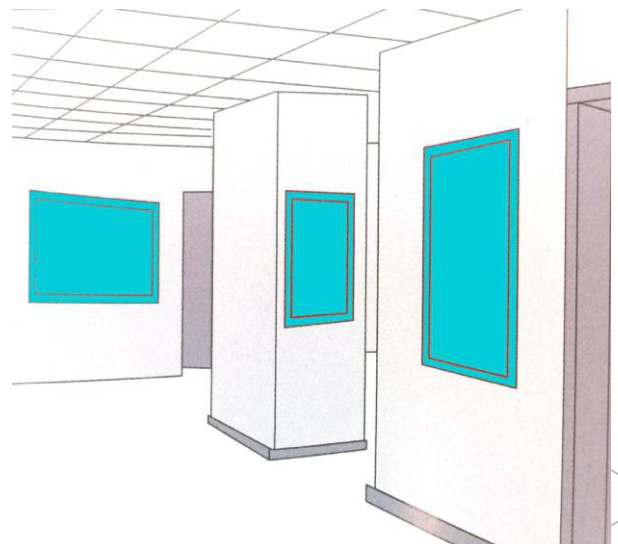

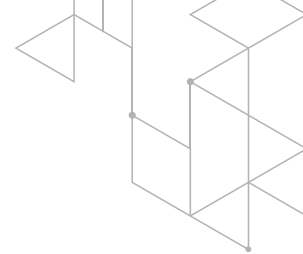

## General Specifications

### LIGHT WEB TECHNOLOGY™ :

3D etched patterns to evenly distribute light throughout the panel. Patterns available are GRID, DOT and MICRODOT™

### THICKNESS:

15/16"

### MAXIMUM SIZE AND PROPORTIONS:

• HEIGHT 96" X WIDTH 48"

### MINIMUM SIZE:

• H 6" X W 6"

### POWER OPTIONS:

24VDC Standard and 24VDC High Power

### DRIVER INPUT VOLTAGE :

100V TO 480V

### LONG LIFE :

Over 50,000 hours = Nearly 12 years based on 12 hours a day. Once installed, the LightPanel System is virtually maintenance free.

### WATTAGE :

4.3 W/Ft. - 24V Standard Power (Optional: 12V)  
5 W/ Ft. - 24V - High Power  
\*ask eos specialist for information on RGB, RGBW and Color Tuning options.

### DIMMABLE :

The system is dimmable to <10% when matched with Dimmable Power Supplies

### LEDs :

ANSI Binned LEDs from Tier 1 Suppliers  
LED CRI > 80, 95+ Premium option  
LED CRT - 1800K - 7500K, RGBW, RGB, Tunable, UV

### WIRE GAUGE:

20GA Wiring for White and Color Tuning Panels, 24GA for Color

### SERVICE AND INSTALLATION :

The Slim ImageArt MediaFrame comes with standard keyhole surface mounts, optional suspension mounts are also available.

## Optional Specifications



### COMPATIBLE POWER SUPPLIES :

- 0-10V dimming • DMX/DALI
- Electronic low voltage (ELV)
- RF Dimmable Plug In
- Inline Dimmable Plug-In



### OUTPUT OPTIONS:

24V Standard Power or 24V High Power available. 12V available upon request



### COLOR TEMPERATURES :

- 1800K • **2400K** • **2700K** • **3000K**
- 3500K • **4000K** • 5000K
- **6000K** • **6500K** • 7500K
- UV (Ultraviolet) • RGB, RGBW and Color Tuning options available

\*formerly 5300K

**Bolded** colors are commonly available in stock.



### APPROVALS AND CERTIFICATIONS:

The System is UL listed for Architectural applications and UL recognized for signage. All power supplies are UL / ETL listed.



<https://eoslight.com/user-guide/>



DOWNLOAD OUR  
USER GUIDE FOR WIRING &  
INSTALLATION INSTRUCTIONS



# Product Specification Ordering Form

NAME:

PROJECT NAME:

ADDRESS:

PHONE:

PROJECT LOCATION:

CITY:

EMAIL:

ANTICIPATED DELIVERY DATE:

ZIP CODE:

COMPANY NAME:

PROJECT SPECIFIER:

RUSH PROJECT: ☐ Yes ☐ No

	A	B	C1	C2	D	E	F	G	H	I	J
	↓	↓	↓	↓	↓	↓	↓	↓	↓	↓	↓
QTY	FIXTURE TYPE	VOLTAGE	DIMENSIONS (INCHES) TOP SIDE		LED SIDES	COLOR TEMP	LED POWER	CORD LENGTH	CORD LOCATION	CORD COLOR	POWER SUPPLY
5	SI	24V	48	50	4SL	2700	SP	CC6	TL	BC	HW

## A FIXTURE TYPE

SI - SLIM IMAGEART Media

## B VOLTAGE

24V - 24V (Standard)

12V - 12V (Optional)

## C DIMENSIONS

(Generated by Client)

C1- Top Dimension

C2- Side Dimension

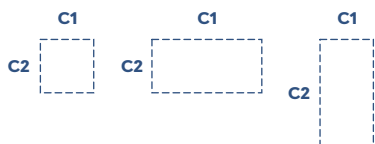

## D LED SIDES

1SL - One Side

2SL - Two Sides

3SL - Three Sides

4SL - Four Sides

Top Dimension

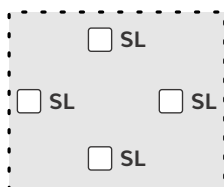

Side Dimension

\*Please note, the longest length is typically the LED side when selecting 1SL or 2SL

## E COLOR TEMP

1800 - 1800K

2400 - 2400K

2700 - 2700K

3000 - 3000K

3500 - 3500K

4000 - 4000K

5000 - 5000K

6000 - 6000K

6500 - 6500K

7500 - 7500K

UV - Ultraviolet

RGB - Color Changing

RGBW - Color Changing  
+ White (6000K, 4000K,  
2700K)

CT- Color Tuning  
(2400K to 6000K)

## F LED POWER

SP- Standard Power

HP- High Power

PSP- Premium Standard Power (95+ CRI)

PHP- Premium High Power (95+ CRI)

## G POWER CORD LENGTH

SC - Standard 9'

CC - Custom (16' max) \_\_\_\_\_

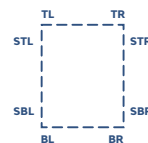

## H POWER CORD EXIT

TL - Top Left Corner

TR - Top Right Corner

STL - Side Top Left Corner

STR - Side Top Right Corner

BL - Bottom Left Corner

BR - Bottom Right Corner

SBL - Side Bottom Left Corner

SBR - Side Bottom Right Corner

## I POWER CORD COLOR

BC - Black

WC - White

## J POWER SUPPLY INFO

010V - 010V Dimmable Hardwire

ELV - Electronic Low Voltage Dimmable  
Hardwire

DMX - DMX /DALI

PI - Plug In, DC Jack

DPI - Dimmable Plug in w/ remote

HW - Non-Dimmable Hardwired

PROJECT NAME:

**PROJECT LOCATION:**

# Please fill out the form

[illegible]

### 1. What is the Application the panels will be used for?

E.g.: Hospitality, Retail, Signage Etc.

## 2. What are the LightPanels backlighting?

E.g.: Stone, Graphic, Glass, Acrylic Etc.

### 3. Will the LightPanels be installed adjacent to one another?

☐ Yes ☐ No

If Yes, Please Provide Drawing of Panel Layout

4. Will the LightPanels be powered individually (1:1) or would you like to connect Multiple LightPanels to a single driver?

### 5. Are there any installation details to review?

**5. Is there an existing Dimming or Lighting Control System?**

If so, please provide Representative with information of the Control system (specs, manufacturer, etc.)

**Additional information:**