

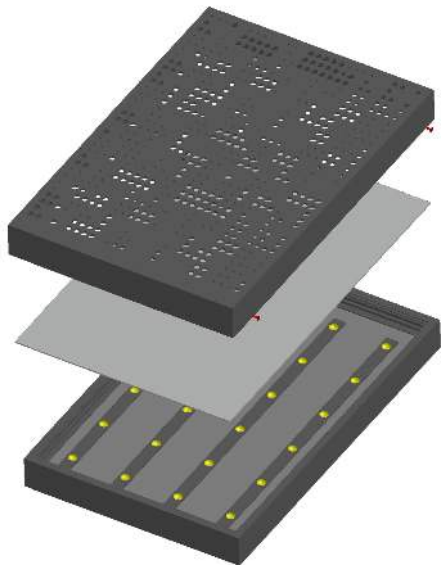

# METALCLOUD

## with Backlit Modules for Outdoor

- MetalCloud is a perforated metal luminaire engineered for exterior performance, powered by EOS Backlit Module technology. Indoor Rated IP20 and Outdoor Rated IP65.
- Designed to withstand diverse environmental conditions, the integrated backlit engine ensures uniform illumination while protecting the light source within a durable metal enclosure. The result is a refined architectural fixture that delivers both structural integrity and visual softness.
- MetalCloud is suitable for indoor, outdoor, and damp locations, offering reliable performance in high-humidity and high-temperature environments.



**Hundreds of designs to choose from!  
Custom designs available.**

### FEATURES

- Perforated metal enclosure for structural strength and long-term durability
- Suitable for damp and high-humidity environments
- Rated for temperatures up to 50°C
- Slim 3" depth profile
- Low-maintenance system once installed

### APPLICATIONS



HOSPITALITY

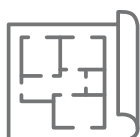

COMMERCIAL  
EXTERIOR



RESTAURANT



PUBLIC SPACES



OUTDOOR



RETAIL



HEALTHCARE



# GENERAL SPECIFICATIONS

## BACKLIT MODULE ENGINE

160° lens mounted directly on to the LED modules for even illumination.

## THICKNESS

3" Depth

## POWER OPTIONS

24VDC Standard

## MAX DIMENSIONS

48" x 120"

## DRIVER INPUT VOLTAGE

100V TO 480V

## WATTAGE

15W/sqFt.

## DIMMABLE

The system is dimmable to <10% when matched with Dimmable Power Supplies

## WIRE GAUGE

20GA Wiring for White Panels, 24GA for Color

## DAMP LOCATION RATED

All Outdoor Fixtures are Damp Location Rated when driven with a Class 2 Power Supply.

## IP RATNG

Indoor Rated IP20  
Outdoor Rated IP65

## MOUNTING

METALCLOUD Luminaires Backlit Modules come with standard keyhole surface mounts. Optional Z-clip or aircraft cable suspension mounts are also available.

## LIFETIME

Over 50,000 hours = Nearly 12 years based on 12 hours a day usage.  
Once installed, the Cloud System is virtually maintenance free.

## WARRANTY

5 years warranty according to the EOS Policy available [here](#).

# OPTIONAL SPECIFICATIONS



## COMPATIBLE POWER SUPPLIES

0-10V dimming | DMX/DALI  
Electronic low voltage (ELV)  
RF Dimmable Plug In  
Inline Dimmable Plug-In



## COLOR TEMPERATURES

1800K - 2400 K - 2700 K - 3000 K -  
3500 K - 4000 K - 5000 K - 6000 K -  
6500 K - 7500 K - UV (Ultraviolet) -  
Tunable white -  
RGB/RGBW/RGBA available

## APPROVALS AND CERTIFICATIONS

The System is UL listed for Architectural applications and UL recognized for signage. All power supplies are UL / ETL listed.



# TECHNICAL SPECIFICATIONS

Section View

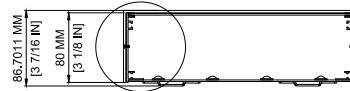

Custom Metal design with 90 degree angle

Opal Diffuser

Flush Screw

Backlit Modules  
Key hole mount

Section Detail

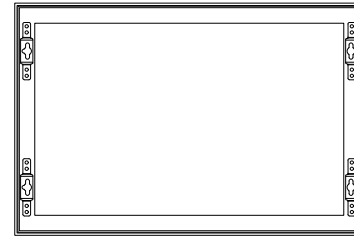

Back Side of Fixture

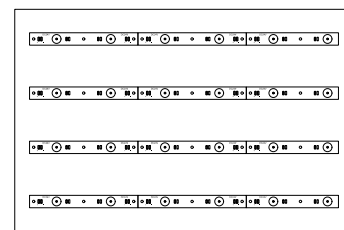

Internal Light Modules

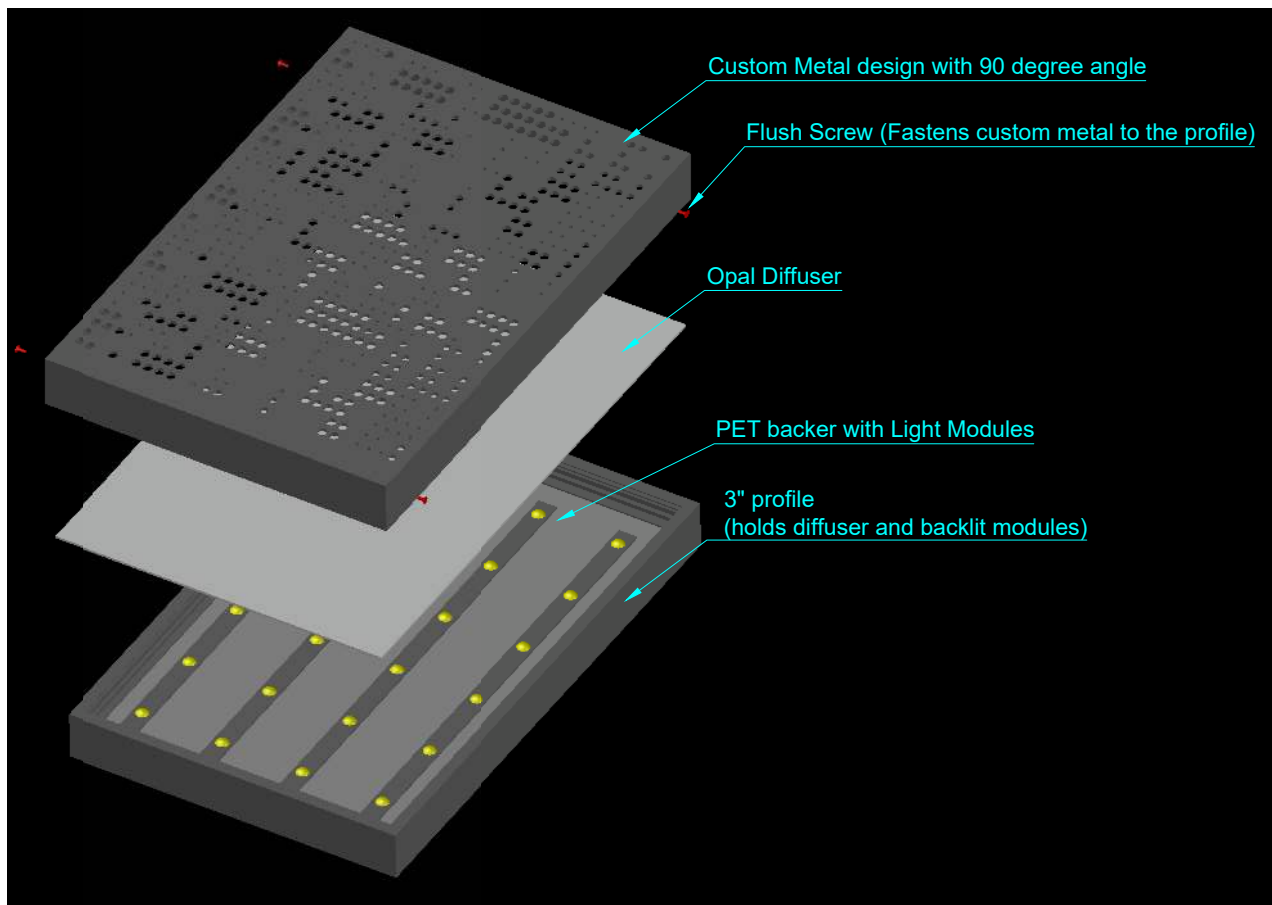



# SPECIFICATION FORM

NAME: \_\_\_\_\_ PROJECT NAME: \_\_\_\_\_ ADDRESS: \_\_\_\_\_

PHONE: \_\_\_\_\_ PROJECT LOCATION: \_\_\_\_\_ CITY: \_\_\_\_\_

EMAIL: \_\_\_\_\_ ANTICIPATED DELIVERY DATE: \_\_\_\_\_ ZIP CODE: \_\_\_\_\_

COMPANY NAME: \_\_\_\_\_ PROJECT SPECIFIER: \_\_\_\_\_ RUSH PROJECT: Yes  No

QTY	FIXTURE TYPE	VOLTAGE	DIMENSIONS		METAL PATTERN	COLOR TEMP	LED POWER	CORD LENGTH	CORD LOCATION	CORD COLOR	POWER SUPPLY
			TOP	SIDES							
3	MC	24V	48	50	1	WT	SP	CC9	TL	BC	HC
	<b>A</b>	<b>B</b>	<b>C</b>		<b>D</b>	<b>E</b>	<b>F</b>	<b>G</b>	<b>H</b>	<b>I</b>	<b>J</b>

## A: FIXTURE TYPE

**MC** - METALCLOUD with Backlit Modules for Outdoor

## B: VOLTAGE

**24V** - 24V (Standard)  
**12V** - 12V (Optional)

## C: DIMENSIONS

(Generated by Client)  
**C1** - Top Dimension  
**C2** - Side Dimension

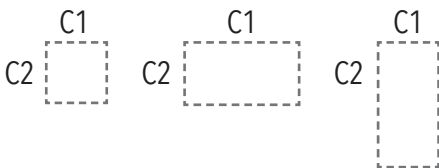

## D: METAL PATTERN

- 1** - Pattern #1
- 2** - Pattern #2
- 3** - Pattern #3
- CU** - Custom

## E: COLOR TEMPERATURE

**WT** - White Static only  
**1800** - 1800K **4000** - 4000 K  
**2400** - 2400 K **5000** - 5000 K  
**2700** - 2700 K **6000** - 6000 K  
**3000** - 3000 K **6500** - 6500 K  
**3500** - 3500 K **7500** - 7500 K  
**TW** - Tunable White  
**RGB** - RGB  
**RGBW** - RGBW  
**RGBA** - RGBA

## F: LED POWER

**SP** - Standard Power (15W/sqFt)

## G: POWER CORD LENGTH

**SC** - Standard - 9.8 ft.  
**CC** - Custom Length \_\_\_\_\_ ft

## H: POWER CORD EXIT

**TL** - Top Left Corner  
**TR** - Top Right Corner  
**STL** - Side Top Left Corner  
**STR** - Side Top Right Corner  
**BL** - Bottom Left Corner  
**BR** - Bottom Right Corner  
**SBL** - Side Bottom Left Corner  
**SBR** - Side Bottom Right Corner

## I: POWER CORD COLOR

**BC** - Black  
**WT** - White

## J: POWER SUPPLY INFO

**010V** - 010V Dimmable Hardwire  
**ELV** - Electronic Low Voltage Dimmable Hardwire  
**DMX** - DMX /DALI  
**PI** - Plug In, DC Jack  
**DPI** - Dimmable Plug in w/ remote  
**HW** - Non-Dimmable Hardwired

