

# LIGHTSLAB™

- LightSlab™ is an integrated backlighting panel system specifically designed for natural stone applications, combining a precision-engineered acrylic base with LED LightPaper to create a durable and high-performance illumination solution. The acrylic slab acts as a protective and structural layer, preventing damage to the LED sheet while ensuring a consistent, even glow across the stone surface.
- Engineered as a complete, ready-to-install system, LightSlab™ is created to be cut and customized directly in the field, allowing seamless adaptation to any design or installation requirement. Its simplified, plug-and-play approach reduces installation time while maintaining a clean and reliable result. Backed by a patent-pending design, LightSlab™ offers a smarter, more flexible way to achieve beautifully backlit natural stone surfaces.

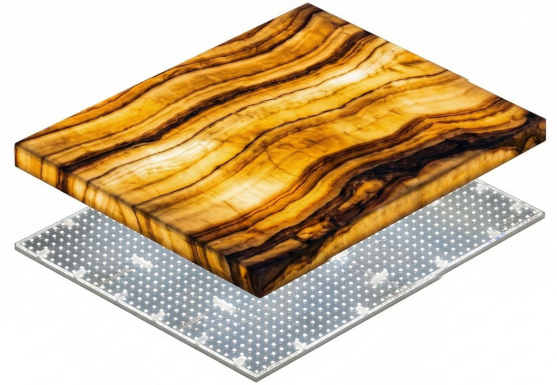

LightSlab™ - Backlit Stone Application

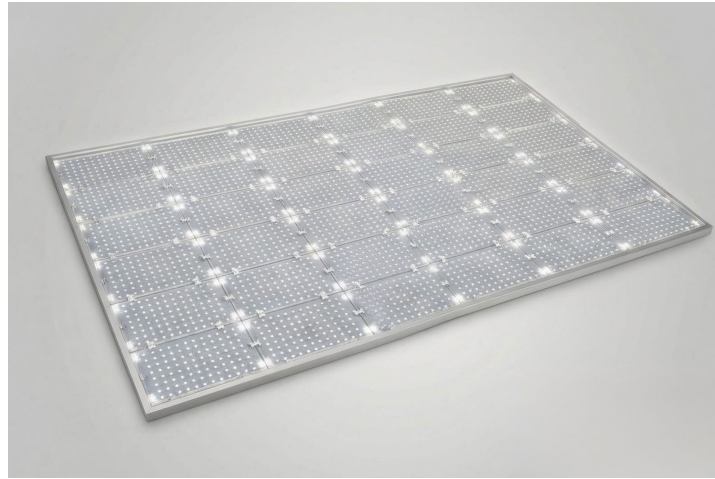

## FEATURES

- Integrated Backlighting Platform
- Uniform Power Distribution
- Field-Cut Adaptive System
- Completely Flat Structural Support
- Protected & Modular LED Integration

## APPLICATIONS



HOSPITALITY



COMMERCIAL INTERIOR



RESTAURANT



BARS



RESIDENTIAL



RETAIL



HEALTHCARE

# GENERAL SPECIFICATIONS

## SUBSTRATE MATERIAL

Cast cell acrylic (not extruded). >92% light transmission at 3mm per ASTM D1003. Superior laser-engraving quality, dimensional stability, resistance to yellowing.

## STANDARD SIZE

113.4" x 75.5625" (in)  
9.45' x 6.3' (ft)  
2880 x 1920 (mm)

## POWER OPTIONS

24VDC Standard

## DRIVER INPUT VOLTAGE

100V TO 277V  
(via external Class 2 LED driver)

## WATTAGE

16.15W/sq ft

## SUBSTRATE THICKNESS

Standard: 0.500" (12.7mm) for stone  
Range: 0.125" min to 2.000"+ by application  
Thick = structural stone support  
Thin = lightweight panels, signage

## DIMMABLE

Dimmable to <10% when paired with dimmable power supplies

## WIRE GAUGE

20 AWG – White & Tunable White  
24 AWG – RGB/RGBW Color

## IP RATNG

Indoor Rated

## LEDs

80+ CRI  
90+ CRI  
2400K, 2700K, 3000K, 3500K, 4000K, 5000K,  
6000K, Tunable White (3000K-6000K)  
RGB and RGBW available

## MOUNTING

Drill on any safe-cut grid line and fasten with standard screws/bolts. No proprietary hardware. Horizontal: stone rests directly on acrylic.

## LIFETIME

Over 50,000 hours = ~12 years at 12hr/day. Virtually maintenance free once installed.

## WARRANTY

5 years warranty according to the EOS Policy available [here](#).

## HOSPITAL & MRI SAFE

Non-ferrous acrylic substrate. Power supply installed remotely, up to 30 ft from application.

## FIELD CUTTING

Cutttable along printed safe-cut grid (every 1" sq) using straightedge scoring + flush-trim router. No CNC required.

# OPTIONAL SPECIFICATIONS



## COMPATIBLE POWER SUPPLIES

0-10V dimming | DMX/DALI  
Electronic Low Voltage (ELV)  
Plug in DC Jack  
Dimmable Plug in w/ Remote  
TRIAC / Phase Dimming



## COLOR TEMPERATURES

2400K - 2700K - 3000K - 3500K -  
4000K - 5000K - 6000K  
Tunable white (3000K - 6000K)  
RGB and RGBW available

## APPROVALS AND CERTIFICATIONS

The System is UL listed for Architectural applications and UL recognized for signage. All power supplies are UL / ETL listed.





# SPECIFICATION FORM

NAME: \_\_\_\_\_ PROJECT NAME: \_\_\_\_\_ ADDRESS: \_\_\_\_\_

PHONE: \_\_\_\_\_ PROJECT LOCATION: \_\_\_\_\_ CITY: \_\_\_\_\_

EMAIL: \_\_\_\_\_ ANTICIPATED DELIVERY DATE: \_\_\_\_\_ ZIP CODE: \_\_\_\_\_

COMPANY NAME: \_\_\_\_\_ PROJECT SPECIFIER: \_\_\_\_\_ RUSH PROJECT: Yes  No

QTY	FIXTURE TYPE	VOLTAGE	DIMENSIONS	SUBSTRATE THICKNESS	COLOR TEMP	LED POWER	CORD LENGTH	CORD COLOR	POWER SUPPLY
3	LS	24V	STD	375	2400	SP	SC	BC	5N1



## A: FIXTURE TYPE

**LS** - LightSlab™

## B: VOLTAGE

**24V** - 24V (Standard)

## C: DIMENSIONS

**STD** - Standard Size  
113.4" x 75.5625"  
(2880 X 1920 mm)

## D: SUBSTRATE THICKNESS

**375** - 0.375"  
**CU** - Custom

## E: COLOR TEMPERATURE

- 2400** - 2400 K
- 2700** - 2700 K
- 3000** - 3000 K
- 3500** - 3500 K
- 4000** - 4000 K
- 5000** - 5000 K
- 6000** - 6000 K
- TW** - Tunable White
- RGB** - RGB
- RGBW** - RGBW

## F: LED POWER

**SP** - Standard Power (16.15W/sqFt)

## G: CORD LENGTH

**SC** - Standard -9.8 ft.

## H: CORD COLOR

**BC** - Black

## I: POWER SUPPLY

**5N1** - 5 in 1  
Comes with Plug In DC Jacks for Testing

## SHIPPING DIMENSIONS

**\*\*5 Qty - (1 Case)\*\***  
 Dims: 119" x 75.5625" x 22" (9.9' x 5.2' x 1.8')  
 Weight: \*\* ~300kg (661lbs) \*\*  
 CBM: ~2.65m³ (~93.4cu ft)

**\*\*10 Qty - (1 Case)\*\***  
 Dims: 119" x 75.5625" x 37" (9.9' x 5.2' x 3.1')  
 Weight: \*\* ~600kg (1322lbs) \*\*  
 CBM: ~4.57m³ (~161cu ft)

## ORDERING QUANTITIES

**CU** - Custom orders are allowed, but standard pricing is for multiples of 5 and 10 quantities.



# POWER DISTRIBUTION

LightSlab™ | 6 x 6 | 4 x 288W Drivers | Quadrant Layout

2880 x 1920mm | 36 modules at 20W per sheet | 80W per lead | % Buffer

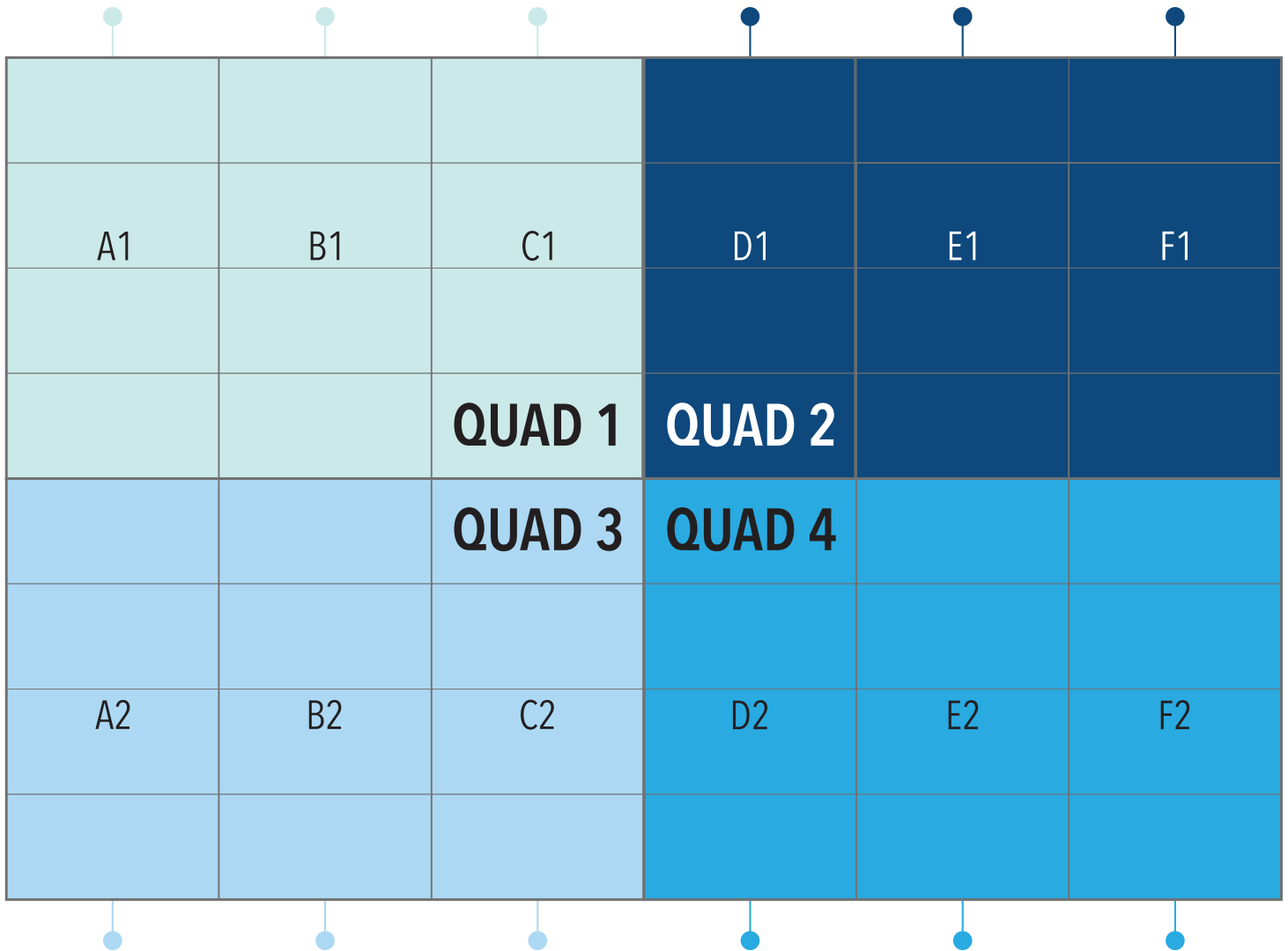

- QUAD A - Driver 1:** A1 + B1 + C1 = 240W - Top Left - Top 3 cords left side
- QUAD A - Driver 2:** D1 + E1 + F1 = 240W - Top Right - Top 3 cords left side
- QUAD A - Driver 3:** A2 + B2 + C2 = 240W - Bottom Left - Bottom 3 cords left side
- QUAD A - Driver 4:** D2 + E2 + F2 = 240W - Bottom Right - Bottom 3 cords left side

Top cords left  QUAD A | Top cords right  QUAD B  
 Bottom cords left  QUAD C | Bottom cords right  QUAD D

# CUSTOMIZATION DETAILS

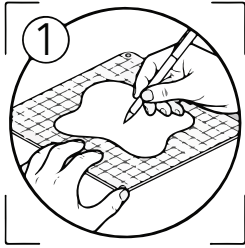

## Mark

Use the printed grid to mark the custom shape. Snap to the nearest safe-cut line.

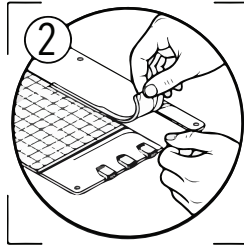

## Score and Peel

Score along the pre-scored lines and peel away unwanted PCB sections. Cap unused connectors.

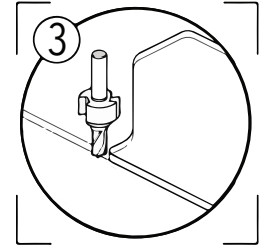

## Route

Route the acrylic to match using a standard flush-trim bit. The remaining PCB edge acts as the natural guide.

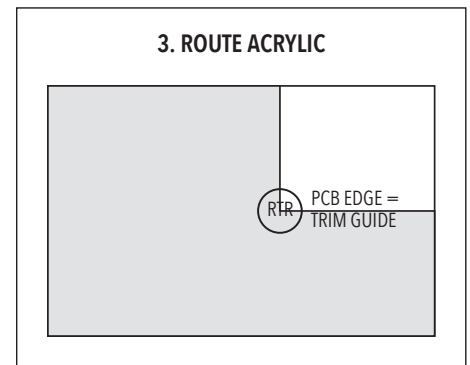
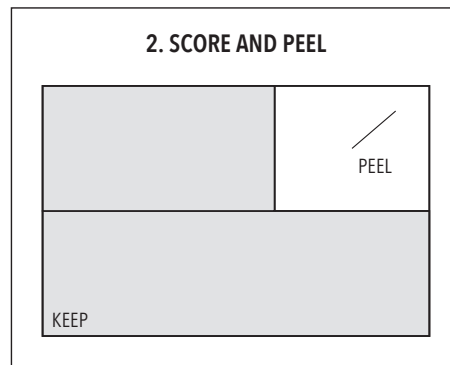
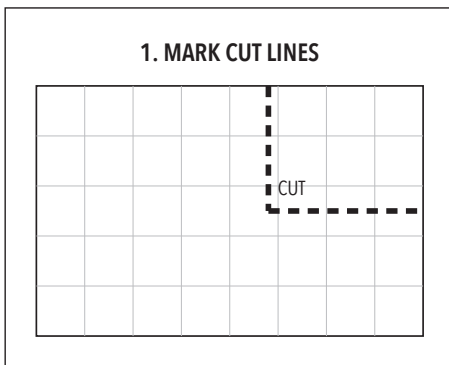

PARALLEL ELECTRICAL TOPOLOGY – REMAINING SECTIONS OPERATE AT FULL BRIGHTNESS AFTER CUTTING

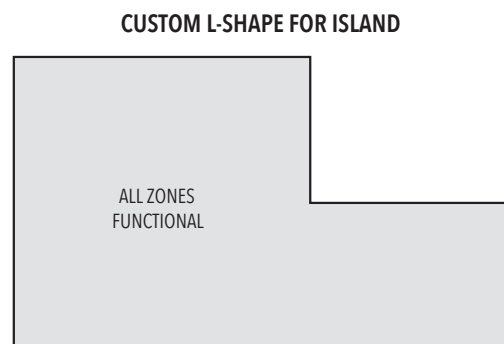
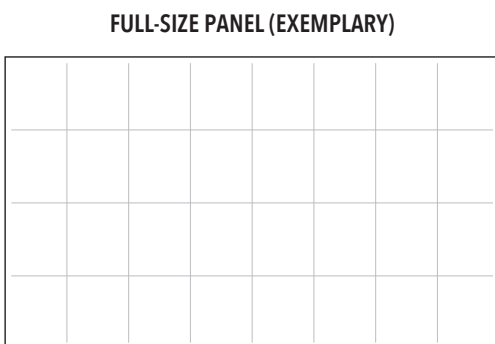

# CUSTOMIZATION DETAILS

## GRID LAYOUT PER SHEET

Each sheet has 288 LED's (24x12)

18.875 x 9.4375 in | 480 x 240 mm

	1	2	3	4	5	6	7	8	9	10	11	12	13	14	15	16	17	18	19	20	21	22	23	24
1																								
2																								
3																								
4																								
5																								
6																								
7																								
8																								
9																								
10																								
11																								
12																								

## GRID LAYOUT PER QUADRANT

Each quadrant has 16 sheets

56.6875 x 37.8125 in | 1440 x 960 mm

SHEET 1	SHEET 2	SHEET 3	SHEET 4
SHEET 5	SHEET 6	SHEET 7	SHEET 8
SHEET 9	SHEET 10	SHEET 11	SHEET 12
SHEET 13	SHEET 14	SHEET 15	SHEET 16

# CUSTOMIZATION DETAILS

## GRID LAYOUT PER LIGHT PANEL

Each LightPanel has 4 Quadrants

113.4 x 75.5625 in | 2880 x 1920 mm

	QUADRANT 1				QUADRANT 2		
	QUADRANT 3				QUADRANT 4		

18432 LED's per LightPanel

64 sheets per LightPanel

4 Quadrants per LightPanel