

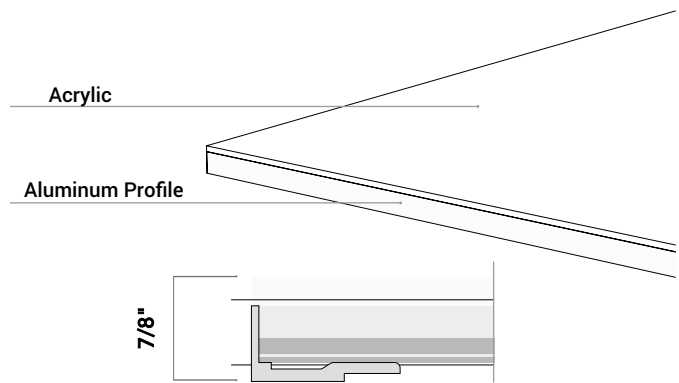

AURA LightPanel SYSTEM

The **AURA** LightPanel System is a complete backlit solution – specifically for wall applications – that utilizes our LightPanel to uniformly distribute light edge to edge and provides an even beautiful glow.

The **AURA** LightPanel allows designers to have a clean acrylic face and glowing edge with the aluminum profile hidden.



The AURA LightPanel allows designers to back light custom shapes in a number of applications:



Hospitality



Retail



Healthcare



Residential



Accent Lighting



Branding



Commercial Interior



Millwork



Cove Lighting



Task Lighting



Custom Fixtures



Logos and Signage

General Specifications

SURFACE APPEARANCE

Edge-to-Edge, glowing, clean acrylic surface (matte or glossy) with an aluminum profile.

MAXIMUM SIZE :

96" x 48" (consult with eos specialist for recommendations with oversize panels)

MINIMUM SIZE :

3" X 3"

THICKNESS:

7/8"

LONG LIFE :

Over 50,000 hours = Nearly 12 years based on 12 hours a day. Once installed, the LightPanel System is virtually maintenance free.

IP RATNG:

Indoor Rated

POWER OPTIONS:

24VDC Standard and 24VDC High Power, 12VDC Available upon request

DRIVER INPUT VOLTAGE :

100V TO 480V

WATTAGE :

4.3 W/Ft. - 24V Standard Power (Optional: 12V)
5 W/ Ft. - 24V - High Power
*ask eos specialist for information on RGB, RGBW and Color Tuning options.

DIMMABLE :

The system is dimmable to <10% when matched with Dimmable Power Supplies

LEDs :

ANSI Binned LEDs from Tier 1 Suppliers
LED CRI > 80 standard, 95+ Premium option
LED CRT - 1800K - 7500K
RGB available
RGBW available

WIRE GAUGE:

20GA Wiring for White and Color Tuning Panels, 24GA for Color

HOSPITAL AND MRI SAFE :

The system contains non ferrous materials, making the LightPanel safe for MRI suites. The LightPanel Power supply must be installed remotely, up to 30 feet from the application.

INSTALLATION :

The Aura LightPanel comes with standard French Cleat wall mounting with the cleats pre-installed.

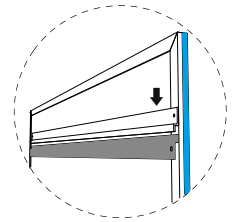

Optional Specifications



COMPATIBLE POWER SUPPLIES :

- 0-10V dimming • DMX/DALI
- Electronic low voltage (ELV)
- Plug in DC Jack • Dimmable Plug in w/ Remote
- TRIAC/ Phase Dimming

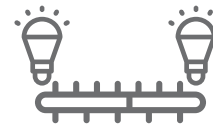

COLOR TEMPERATURES :

- 1800K • 2400K • 2700K • 3000K
- 3500K • 4000K • 5000K • 6000K*
- 6500K • 7500K • UV (Ultraviolet)

*formerly 5300K



MULTIPLE PANEL MOUNTING OPTIONS:

- French Cleats (Z - Profiles)
- Key-Hole Frames



APPROVALS AND CERTIFICATIONS:

The LightPanel System is UL listed for Architectural applications and UL recognized for signage. All power supplies are UL / ETL listed.

<https://eoslight.com/user-guide/>



DOWNLOAD OUR
USER GUIDE FOR WIRING &
INSTALLATION INSTRUCTIONS





Product Specification Ordering Form

NAME:	PROJECT NAME:	ADDRESS:
PHONE:	PROJECT LOCATION:	CITY:
EMAIL:	ANTICIPATED DELIVERY DATE:	ZIP CODE:
COMPANY NAME:	PROJECT SPECIFIER:	RUSH PROJECT: <input type="checkbox"/> Yes <input type="checkbox"/> No

A	B	C1	C2	D	E	F	G	H	I	J	K	L	M
PANEL TYPE	VOLTAGE	DIMENSIONS (INCHES) TOP SIDE		LED SIDES	COLOR TEMP	LED POWER	DIFFUSER	CORD LENGTH	CORD LOCATION	CORD COLOR	POWER SUPPLY	POTENTIAL #	REVISION #
AU	24V	27	48	4SL	3500	SP	ND	SC	BR	BC	010V	26861	REVO

A PANEL TYPE

AU - AURA LightPanel

B VOLTAGE

24V - 24V (Standard)
12V - 12V (Optional)

C DIMENSIONS

(Generated by Client)
C1- Top Dimension
C2- Side Dimension

Round also available -
Please supply
diameter

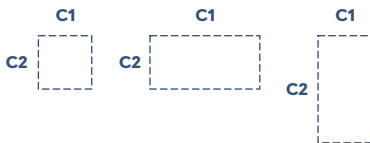

D LED SIDES

- 1SL** - One Side
- 2SL** - Two Sides
- 3SL** - Three Sides
- 4SL** - Four Sides

Top Dimension

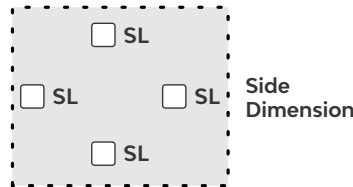

*Please note, the longest length is typically the LED side when selecting 1SL or 2SL

E COLOR TEMP

- 1800** - 1800K
- 2400** - 2400K
- 2700** - 2700K
- 3000** - 3000K
- 3500** - 3500K
- 4000** - 4000K
- 5000** - 5000K
- 6000** - 6000K
- 6500** - 6500K
- 7500** - 7500K
- UV** - Ultraviolet
- RGB** - Color Changing
- RGBW** - Color Changing + White (6000K, 4000K, 2700K)
- CT** - Color Tuning (2400K to 6000K)

F LED POWER

- SP**- Standard Power
- HP**- High Power
- PSP**- Premium Standard Power (95+ CRI)
- PHP**- Premium High Power (95+ CRI)

G OPTIONAL 2MM DIFFUSION OPAL

ND - No Diffuser

H POWER CORD LENGTH

- SC** - Standard -9.8 ft.
- CC_** - Custom Length ____ ft

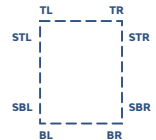

I POWER CORD EXIT

- TL** - Top Left Corner
- TR** - Top Right Corner
- STL** - Side Top Left Corner
- STR** - Side Top Right Corner
- BL** - Bottom Left Corner
- BR** - Bottom Right Corner
- SBL** - Side Bottom Left Corner
- SBR** - Side Bottom Right Corner

J POWER CORD COLOR

BC - Black **WC** - White

K POWER SUPPLY INFO

- 010V** - 010V Dimmable Hardwire
- ELV** - Electronic Low Voltage Hardwire
- DMX** - DMX /DALI
- PI** - Plug In, DC Jack
- DPI** - Dimmable Plug in w/ remote
- TR** - TRIAC/Phase Dimming

L POTENTIAL

Enter Potential # Here

M REVISION

Enter Revision # Here

